

Monton Office

0161 789 8383
222 Monton Road, Monton
M30 9LJ
@homeinmonton



66 Ellaray Road Salford M6 7GZ
£1,250 Per calendar month

OVERLOOKING THE BOWLING GREEN TO THE FRONT! AVAILABLE NOW! HOME ESTATE AGENTS are delighted to offer for rent this immaculate and well positioned three bedroom terrace property which has the added bonus of overlooking the bowling green! Ideally offered with immediate occupation, the property comprises hallway, lounge, dining room, modern fitted kitchen, shaped landing, three DOUBLE bedrooms and modern fitted bathroom suite. There is also a useful storage cellar to the lower ground floor of the property. Externally there is a yard to the front and rear. Situated in a popular area with great access routes to Manchester City Centre and Salford royal hospital. Offered on an un-furnished basis! Call HOME on 01617898383 to view!

- OVERLOOKING THE BOWLING GREEN TO THE FRONT!
- Lounge
- Spacious bedrooms
- Perfect Salford Position!
- Spacious three bedroom terrace property
- Dining room
- Modern fitted bathroom
- Hallway
- Modern fitted kitchen
- Cellar for storage



LOCAL EXPERTS THAT GET YOU MOVING

 www.homeestateagents.com

Lettings info

We are advised that the current council tax band is band B.

The current EPC rating is D



LOCAL EXPERTS THAT GET YOU MOVING

 www.homestateagents.com



Registered Address Vantage House, East Terrace Business Park, Euxton Lane, Euxton PR7 6TB - England
Company Registration numbers Monton - 9262084 Urmston - 04331861 Stretford - 08259553



LOCAL EXPERTS THAT GET YOU MOVING

www.homeestateagents.com



Registered Address Vantage House, East Terrace Business Park, Euxton Lane, Euxton PR7 6TB - England
Company Registration numbers Monton - 9262084 Urmston - 04331861 Stretford - 08259553

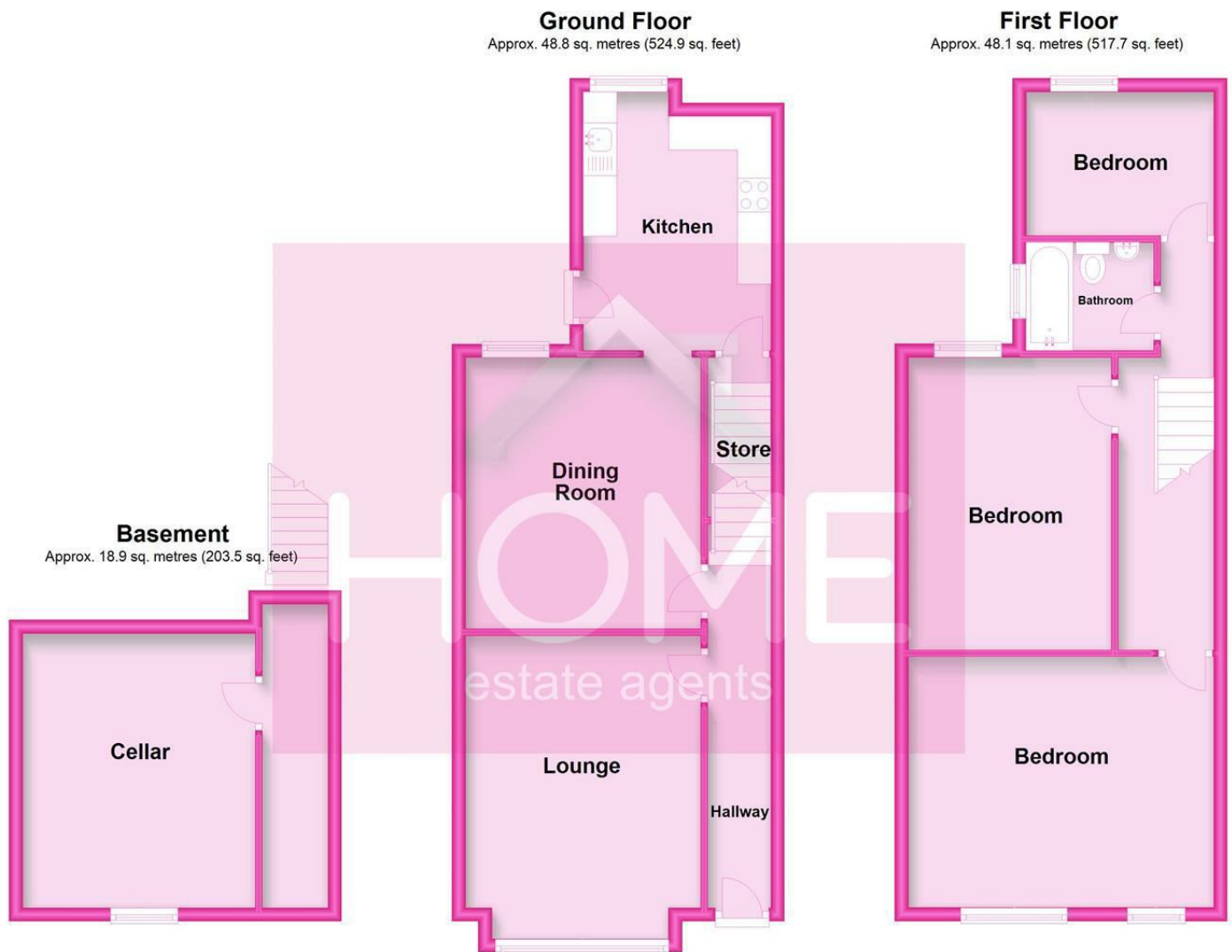

Energy Efficiency Rating		
	Current	Potential
Very energy efficient - lower running costs		
(92 plus) A		
(81-91) B		
(69-80) C		
(55-68) D		
(39-54) E		
(21-38) F		
(1-20) G		
Not energy efficient - higher running costs		
England & Wales	EU Directive 2002/91/EC	

Environmental Impact (CO ₂) Rating		
	Current	Potential
Very environmentally friendly - lower CO ₂ emissions		
(92 plus) A		
(81-91) B		
(69-80) C		
(55-68) D		
(39-54) E		
(21-38) F		
(1-20) G		
Not environmentally friendly - higher CO ₂ emissions		
England & Wales	EU Directive 2002/91/EC	

LOCAL EXPERTS THAT GET YOU MOVING

www.homeestateagents.com



Registered Address Vantage House, East Terrace Business Park, Euxton Lane, Euxton PR7 6TB - England
Company Registration numbers Monton - 9262084 Urmston - 04331861 Stretford - 08259553